

V200 USER MANUAL

1 M/B installation

Put the motherboard on the M/B bracket, align screw holes of the motherboard and the standoffs on the M/B bracket, then fix motherboard on standoffs by screws (Different motherboard has different installation characteristics, it is recommended that you refer to your M/B instruction manual when installing)

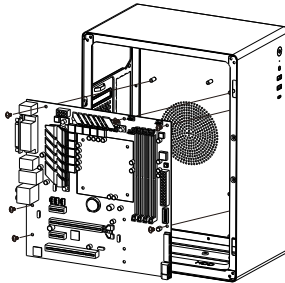

2 PSU installation

Install the power supply in the position as shown and lock the screws at A

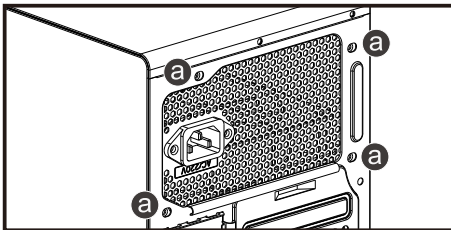

3 VGA card installation

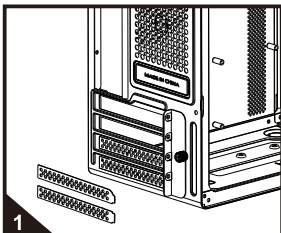

Remove the PCI seal from the rear window here

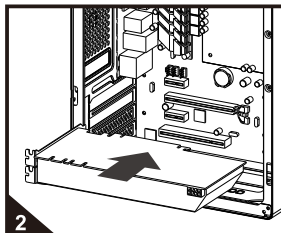

Insert the graphics card into the slot on the motherboard in the direction of the arrow

4 Hard disk installation method

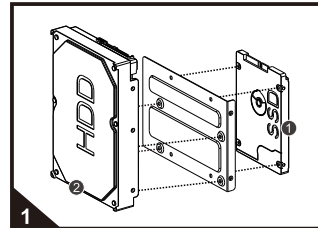

- ① Screw the 2.5" SSD into the drive cage first
- ② Then screw the 3.5" HDD into the HDD cage

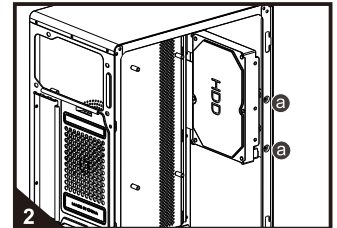

Then fit the hard drive cage into the front panel of the case and lock the screws at A

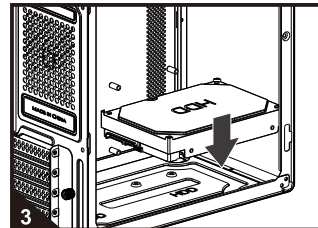

Place the HDD in the position shown and lock the screws from the bottom

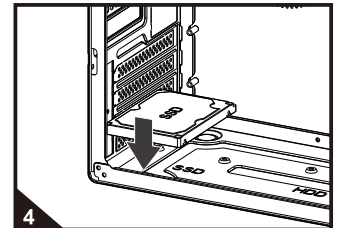

Place the SSD in the position shown and lock the screws from the bottom

5 Cooling system

Rear: 1*8cm cooling fan

